

Directions to the
Communication and
Developmental Lab

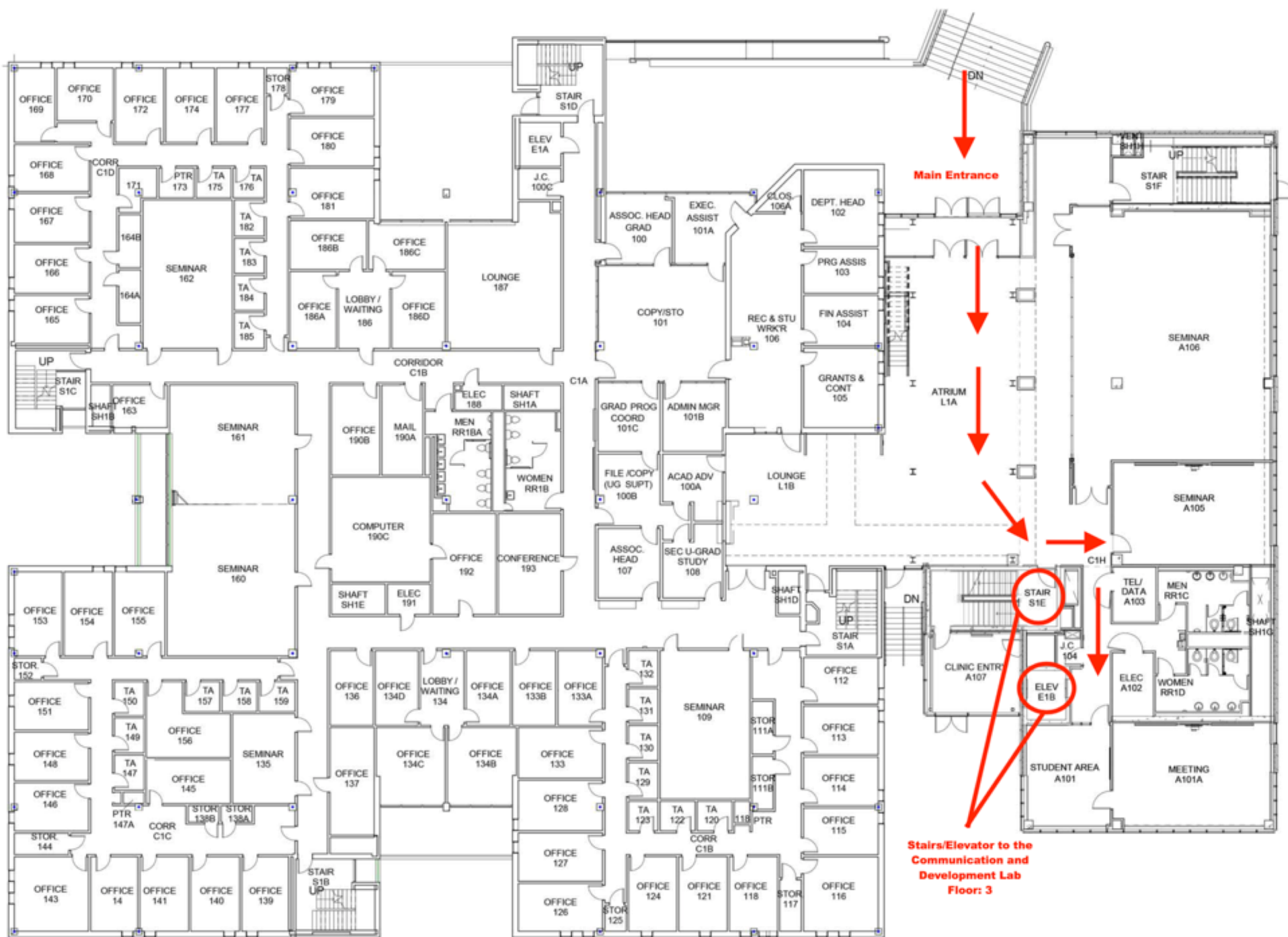

**Stairs/Elevator to the Communication and Development Lab
Floor: 3**



Enter Bousfield's main entrance and go the left

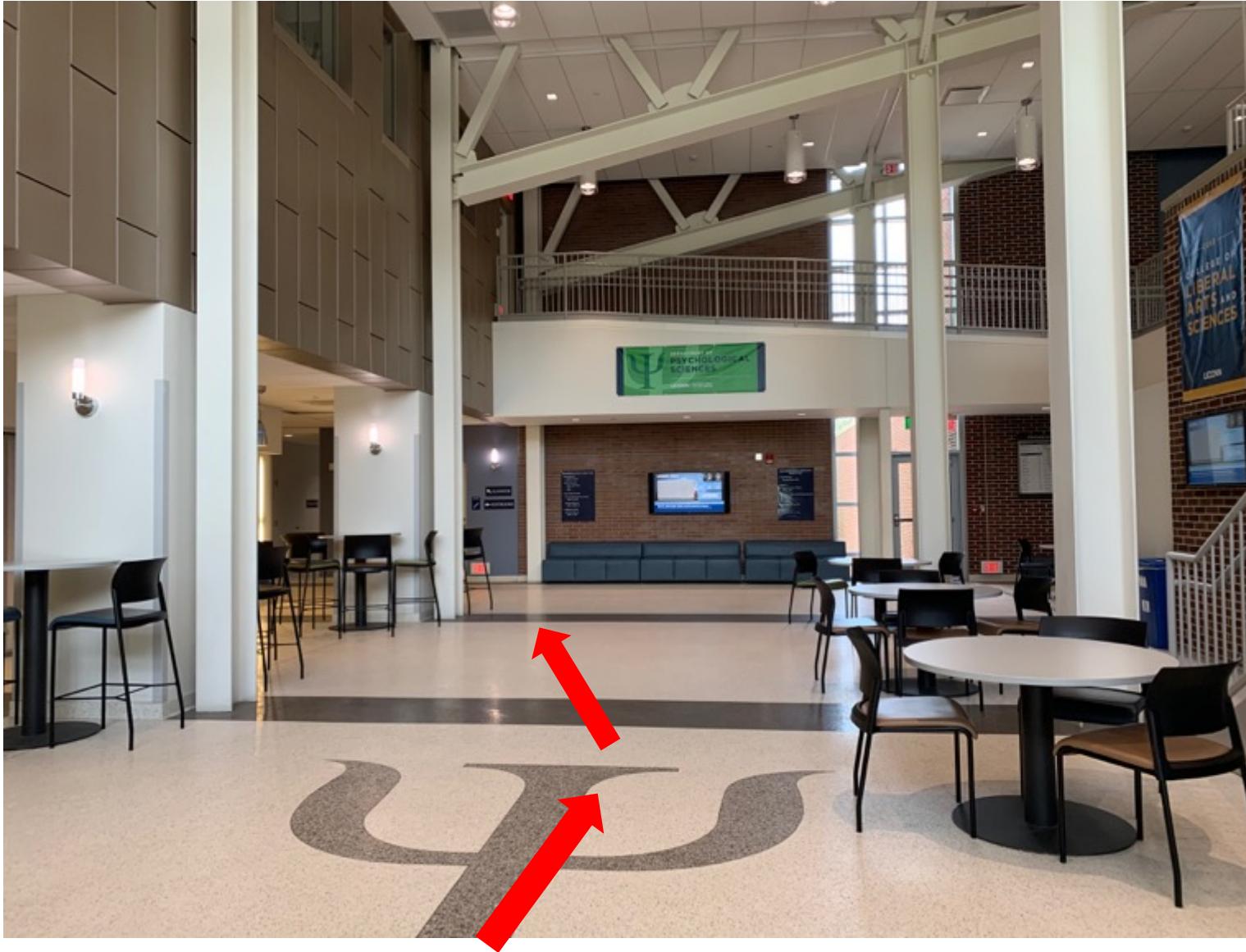

Take the stairs or the elevator to the third floor



If you took the elevator, turn left and you will see a waiting area on the left before reaching the Communication and Development Lab

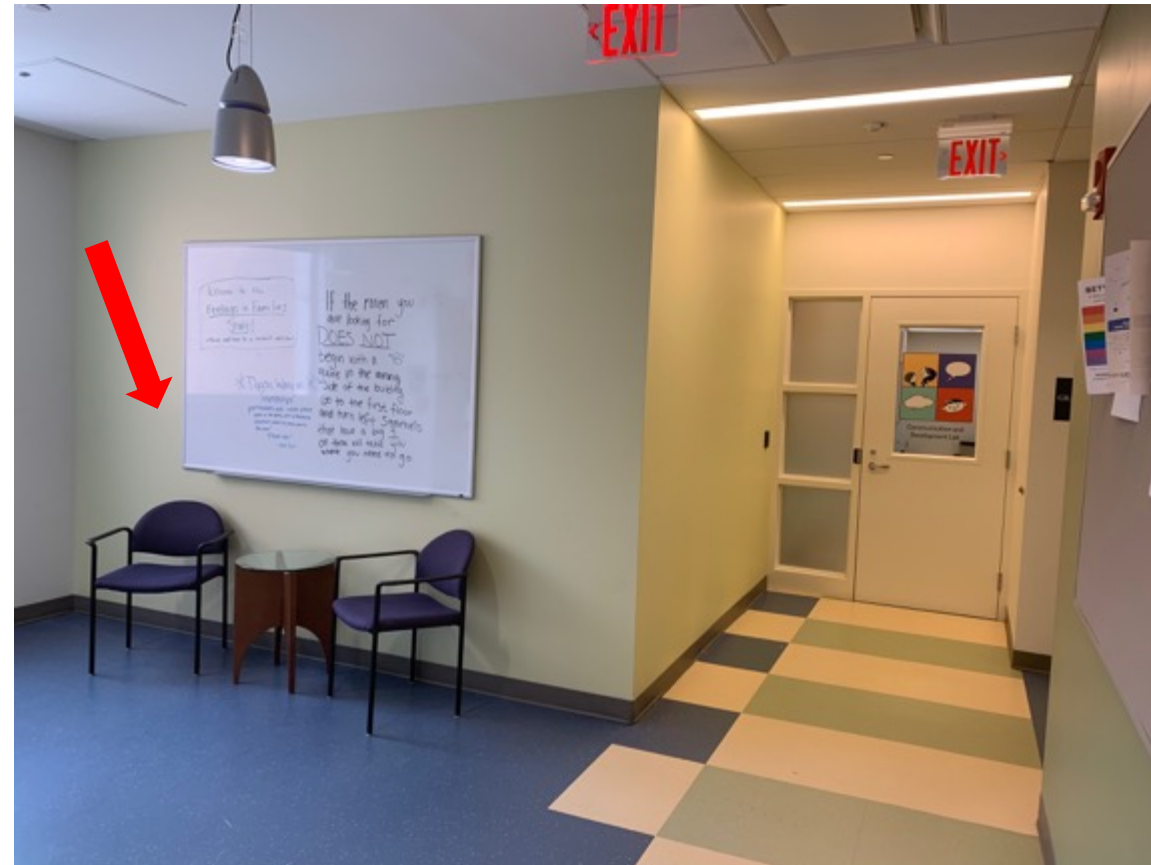

If you took the stairs, the waiting area is directly in front of the door

